

Synchronizer Installation Illustration

1. Install connect axis outside gear

Connect involute splines include ($\Phi 14.73$) inner connection and Outer connection ($\Phi 22.22$).

1.1 Inner Connection

1) Loose the fix screw of the upper wheel, and move the wheel out 3~5mm, not screw down(See Fig.1).

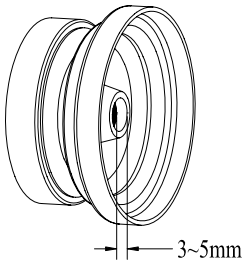

Fig.1

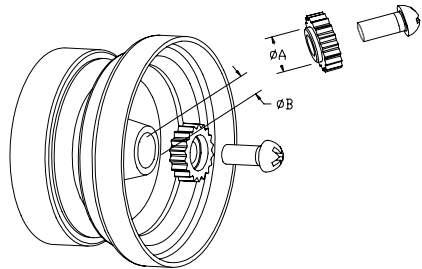

Fig.2

2) Match hole ΦA with the hole ΦB and tight the screw(See Fig.2).

3) Recover the upper wheel to the initial position.

1.2 Outer connection

Make groove ΦA and ΦB match and tight the screw(See Fig.3).

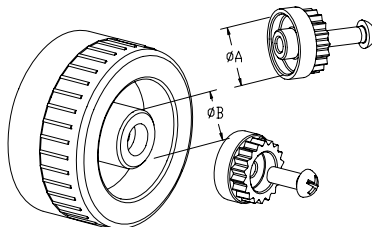

Fig.3

2. Thread Screw L and synchronizer Installation

2.1 The first six angles nut is installed in L type threaded rod, then the type L threaded rod is screwed into the handpiece

Note: Install all kinds of the screws are similar.

2.2 The second external synchronizer and type L threaded rod are tightly matched, as shown in the figure (Figure 4and 5):

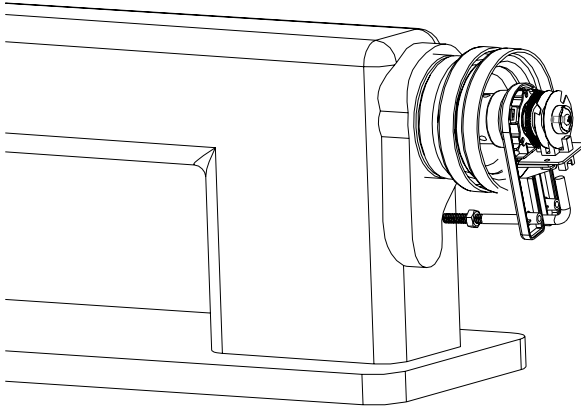

Fig.4

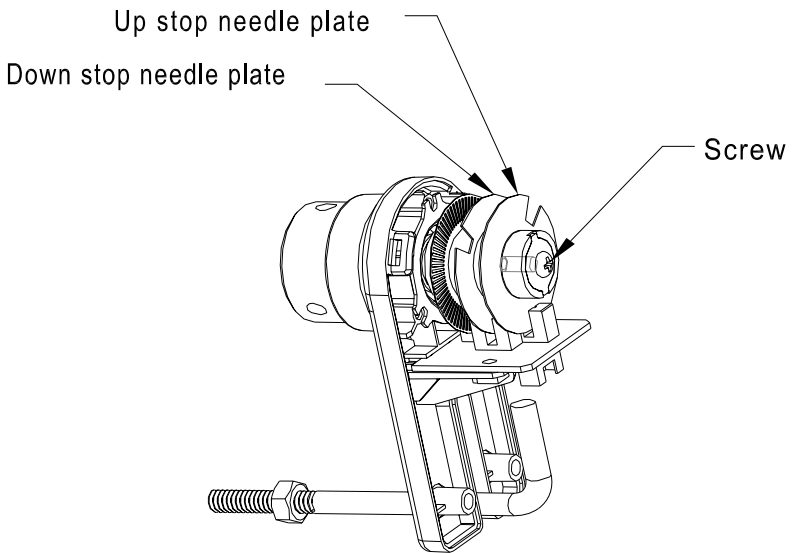

Fig.5

3. Synchronizer Installation measurement explanation(See Fig.6 and Table 1):

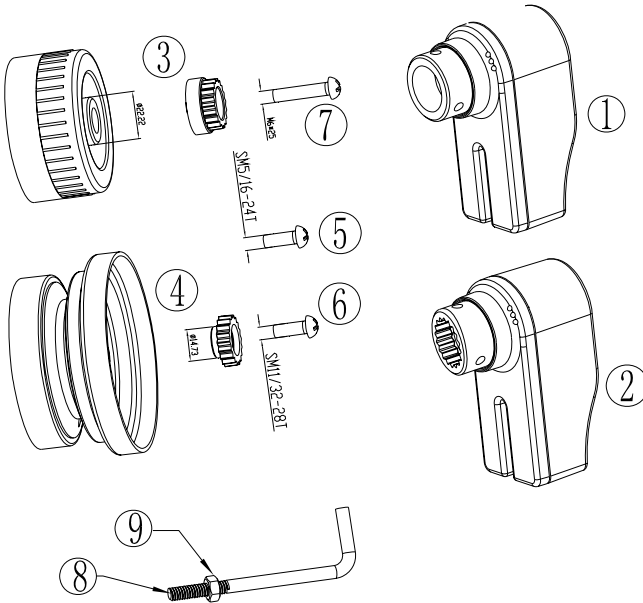

Fig.6

- ① Sensor main assembly (Without internal splines)
- ② Sensor main assembly (With internal splines)
- ③ External splines
- ④ Internal splines
- ⑤ Internal spines connection bolt: SM5/16” *24T
- ⑥ Internal spines connection bolt: SM 11/32” *28T
- ⑦ External splines connection bolt: M6*25mm
- ⑧ L threaded rod
- ⑨ six angles nut